

STATE-OF-THE-ART

WATER FILTRATION SYSTEM



AQUAFLO

RESIDENTIAL | INDUSTRIAL | COMMERCIAL

About Waterco

As a global leader in sustainable solutions, focusing on the area of water, Waterco is committed to providing cost-effective and innovative solutions that contribute to resource optimization and sustainable growth for communities and industries. Established in 1981, Waterco has since become a global brand recognized for designing and manufacturing both filtration and sanitisation innovations for the water purification, swimming pool, spa and aquaculture industry.

It is Waterco's goal to enable our customers to meet increasing water demands and population needs, overcome scarcity challenges, enhance their environmental stewardship and comply with regulatory requirements.

Waterco's head office is in Sydney, Australia, with international offices, warehouses, manufacturing and R&D plants located in US, Australia, New Zealand, Malaysia, Indonesia, Singapore, China, Canada, France, and the UK.

MANUFACTURING POWERHOUSE

The company's advanced fibreglass winding and pioneering plastic moulding techniques have delivered premium quality products to over 40 countries via its branches and international distributors.



Strict quality control

Waterco's quality control procedures ensure that the structural requisites of the product are achieved at every stage of production. This results in 100% compliance of the end product with the specifications.



Seamless one-piece vessel

Waterco's Micron Commercial Fibreglass Filters are made from continuous strands of high quality fibreglass filament wound under controlled tension to create a seamless, impervious vessel. This produces a filter that is free from welds or seams along with special tank linings that typically corrode or electrolyse. Waterco's revolutionary winding technology further strengthens the fibreglass structure so it can withstand a working pressure of up to 1,000 kPa (150psi).



Low maintenance

Once installed, there are virtually no maintenance or repairs required. Steel vessels require the anti-corrosive coating to be maintained periodically and certified welders to make repairs to the lining with expensive epoxy coating.



Proprietary construction

The design and manufacturing process of the fibreglass vessel, utilising the latest filament winding machines, incorporation of non-metallic fittings plus reinforced manhole openings with proprietary methods, is unique to Waterco.



1/3 the weight of steel

Fibreglass vessels weigh only 1/3 the weight of steel vessels while maintaining the same level of strength. Their weight makes them easier to ship to the job site, quicker to install, and reduces structural requirements.



Why you should choose Aquaflo filter for clearer water?



1. What are the benefits of the Waterco Aquaflo water filtration system compared to other water filters in the market?

The Waterco Aquaflo water filtration system comes with multi-media technology that is able to remove and reduce various harmful substances in the incoming water supply. Unlike conventional sand filters that only remove suspended solids, the Waterco Aquaflo uses five layers of filter media, including GAC-Plus/Anthracite, DMI-Plus, ZeoPlus, Graded River Silica Sand and Graded Gravel, which yield higher flow rates and longer service runs.

2. Is stainless-steel filter better than the Waterco Aquaflo water filtration system?

Costly passivation process is required for most of the stainless-steel filters in every few years to ensure its internal wall does not rust and affect the water quality.

The Waterco Aquaflo water filtration system is manufactured from the highest grade of non-corrosive materials and employing the latest in fibreglass winding technology, therefore it is built for many years of trouble-free operation. Unlike the stainless-steel filter, the Waterco Aquaflo water filtration system is chemically inert and will not react with any chemical that might present inside the incoming water supply.

3. Where can the Waterco Aquaflo water filtration system be installed?

The Waterco Aquaflo water filtration system can be installed for the

- ✓ Landed Residential Area & High-Rise Building
- ✓ Hospital & Government Complex
- ✓ Industrial & Manufacturing Facility
- ✓ Hotel, Resort & Theme Park
- ✓ School, College & University
- ✓ Agriculture, Plantation & Aquaculture

4. Is chlorine in the water bad for me? Can the Waterco Aquaflo water filtration system remove chlorine from the municipal water supply?

Chlorine in itself does not appear to be a problem other than the aesthetic concerns of undesirable taste and odour it creates. The Waterco Aquaflo water filtration system offers two different top layer media to suit every individual needs.

Anthracite Pure: It is a high-hardness mineral coal of great carbon content. It is formed, like all mineral coals, by a slow process (millions of years) of plant transformation by effect of pressure and temperature. While it does not remove chlorine; and due to the special shape of its grains, Anthracite Pure allows the suspended particles to be retained in the depth of the filtering bed thus making it an excellent filter media for water clarification in drinking or industrial use.

GAC-Plus: It is known as Granular Activated Carbon, which offers wide range of application in water purification and industrial process liquids. Its porous structure effectively removes dissolved organic matter, pesticides and chemicals in raw water source, while significantly improves water quality. Around 50-60% of chlorine will be removed from the water after being filtered by GAC-Plus, while remaining chlorine will be just enough for disinfection purpose.

5. Beside the state-of-the-art technology of Aquaflo water filtration system, why many customers in the past have chosen the Waterco products?

Waterco was established back in 1981 in Sydney, Australia and it was public listed on the Australia Stock Exchange in 1989. Since then, Waterco has devoted its core business into supplying a wide range of domestic and industrial water filtration system through its wide network of dealers that cover every state in the country. Waterco exports its products to over 40 countries via its offices in Australia, New Zealand, China, Malaysia, Singapore, Indonesia, United Kingdom and the United States of America. Waterco manufacturing plant in Malaysia is ISO 9001 Certified and capable to produce DOSH / JKKKP Certified water filters upon request by the customer.

Scan the following QR code to find out more about the frequent asked questions.



Complete Solution for Domestic & Commercial Water Treatment



SPECIFICATIONS:

Filter Model	Filter Qty	Filter Dimensions	Recommended Filter Flow Rate m³/hr	Filtration Area (m²)	Port Size (mm/Inch)	Nominal Weight (kg)	
						Media (Max.)	Vessel
AQ500X	2	500 x 2000	14 - 19	0.40	40 / 1-1/2"	496	66
AQ600X	2	600 x 2000	20 - 27	0.56	40 / 1-1/2"	767	98
AQ700X	2	700 x 2000	27 - 37	0.76	40 / 1-1/2"	1038	102
AQ600Y	3	600 x 2000	30 - 40	0.84	40 / 1-1/2"	1163	147
AQ700Y	3	700 x 2000	41 - 55	1.14	40 / 1-1/2"	1584	153
AQ700Z	4	700 x 2000	55 - 73	1.52	40 / 1-1/2"	2055	204
AQ1200X	2	1200 x 1800	81 - 109	2.26	80 / 3"	3118	350
AQ1400X	2	1450 x 1800	111 - 148	3.08	80 / 3"	4527	540
AQ1200Y	3	1200 x 1800	122 - 163	3.39	80 / 3"	4627	525
AQ1600X	2	1650 x 1800	145 - 193	4.02	100 / 4"	5540	660
AQ1200Z	4	1200 x 1800	163 - 217	4.52	80 / 3"	6136	700
AQ1600Y	3	1650 x 1800	217 - 290	6.03	100 / 4"	8237	990

Materials of Construction			
Housing	Composite-Fibre-Reinforced Plastic	Installation Pipe	PVC/Stainless Steel/Ductile Iron/Mild Steel/PPR/ABS
Frontal Pipe	PVC	Backwash Pipe	PVC
Media Specifications			
Anthracite-Pure/GAC-Plus/ZeoPlus/Graded River Silica Sand/DMI-Plus/Graded Gravel			

* Waterco Aquaflo water filtration system is equipped with pressure regulating device (optional) to ensure the system can cope with any incoming water pressure spike. Waterco Aquaflo water filtration system is available up to 10bar (145psi) for various site conditions when required.

* Recommended backwash flow rate is based on 40-48m³/hr/m² velocity. If the backwash rate cannot be achieved at the installation site, it would require longer time to backwash and rinse the trapped suspended solids inside the filter.

*Top layer media will be selected based on incoming water condition and requirement.

State-of-The-Art Water Filtration System



GAC-Plus

- Taste and odour removal
- Partial removal of chlorine
- Easy backwashing filter media

Anthracite-Pure

- Light and tough media
- Minimize clogging in subsequent layer
- Easy backwashing filter media

ZeoPlus

- Ammonia & “chlorine” odour removal
- High clarity water production
- Enhanced physical filtration

DMI-Plus

- Infusion technology catalytic media
- Iron-Manganese removal
- Arsenic removal

Graded River Silica Sand

- Physical filtration
- Sediment and suspended solids filtration

Graded Gravel

- Lower bed supporting media
- Increase backwash efficiency

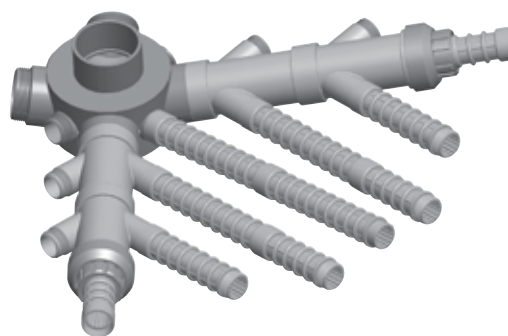

AquaFlo is using hydraulically balanced lateral design to improve its filtration and backwashing hydraulic efficiency. Effective backwashing process reduces the water usage significantly, and this will be reflected on the monthly water bill. Laterals are made with high grade PVC material that designed to last long and minimize the break down or maintenance.



Designed for durability



Water saving



Save money



Low maintenance cost

Testimonials

“ Ever since the Waterco filters were installed, we haven’t received any complaints from the hotel guests about yellowish water in the shower. We are very happy with the filter performance.

Facility Manager – Mr. Teh Ampang

”

“ We have been experiencing water supply with foul odour for many years until the committee decided to install Waterco filtration system. Since then, there has been nothing but satisfied family member and neighbours.

Condominium Resident – Mr Johnson Liew Kepong

”

“ Wish that I could make the right choice the first time when I purchased my POE filter. This is the seventh year I’ve been using Waterco water filtration system, and I am still feeling grateful about the water quality and hassle-free experience.

Landed Property Resident – Ms Kok Cheras

”

“ I felt relief after changing all our existing stainless-steel filters to Waterco FRP filters. No more bill shock from all the hidden service charges. No more concerns coming from resident about the obvious rusty tank surface.

Condominium Management – Mr. KK Teh Kuala Lumpur

”

“ I was just giving a try on FRP filter from Waterco at first, but I was surprised with its performance and low maintenance interval. Now I am going to change all the remaining five stainless-steel filters to cease the expensive maintenance cost.

Manufacturing Plant Owner – Mr. Low Telok Intan

”

“ I am very pleased with the performance of the water filter as I no longer have to worry about yellowish stains on my light colour-based clothes. Previously, I had to install a small filter just for the washing machine to prevent such issues. Now I can finally enjoy problem free laundry days.

Loyal Customer & Housewife – Candy Johor Bahru

”

“ Water quality is the utmost matter we care about as it will affect the quality of our products, we cannot afford to waste the commodity due to bad water quality. Waterco filtration system had been providing consistent water quality without any issue so far, we will definitely get the water filters from Waterco for upcoming expansion.

Poultry Industry – Alex Ipoh

”

pocket
area after
fold

Bridging the Access of Clear Water to the Community...

RESIDENTIAL

Amara Boulevard Condo Batu Caves, Selangor
Belfield Condominium, Kuala Lumpur
Bougainville Tower, Kuala Lumpur
Bungaraya Condominium Subang, Selangor
Casa Subang Subang Jaya, Selangor
Continental Height Jalan Klang Lama, Kuala Lumpur
Dua Sentral, Kuala Lumpur
Fawina Court Ampang Jaya, Selangor
First Residence Condo Kepong, Kuala Lumpur
GCB Court, Kuala Lumpur
I-City Shah Alam, Selangor
Menara Bangsar Condominium, Kuala Lumpur
Palladium Condominium, Kuala Lumpur

Pantai View Bangsar, Kuala Lumpur
Pelita Indah Condominium, Johor Bharu
Petaling 8 Condominium Sri Petaling, Kuala Lumpur
Prima Setapak Condominium, Kuala Lumpur
Ronald McDonald House Charities Cheras, Kuala Lumpur
Saujana Residency Subang Jaya, Selangor
Seri Kasturi Apartment Setia Alam, Selangor
Setapak Green Condominium, Kuala Lumpur
Setapak Ria Condominium, Kuala Lumpur
Southkey Residences Johor Bharu, Johor
University Tower Condominium Petaling Jaya, Selangor
Villa Orkid Condominium Segambut, Kuala Lumpur

INDUSTRIAL

Dindings Poultry Processing S/B Setiawan, Perak
DRB Hicom, Shah Alam
Hock Soon Poultry Farm Sdn Bhd, Bidor, Perak
HUKM (New Wing) Cheras, Selangor
KLIA DCA Tower Sepang, Selangor
Lai Huat Liquid Egg Sdn Bhd, Melaka

Oil Palm Plantation Lahad Datu, Sabah
Pearlye Dobi Lukut, Negeri Sembilan
Perfect Tube Ice Puncak Alam, Selangor
Pusat Perubatan Universiti Malaya, Kuala Lumpur
Regent Food Industries Sdn Bhd Klang, Selangor
Suzuki Latex Industry Malaysia

COMMERCIAL

Amcorp Mall Petaling Jaya, Selangor
Carcosa Seri Negara, Kuala Lumpur
Dynasty Inn Kota Bharu, Kelantan
Eastin Hotel Petaling Jaya, Selangor
Golden Lake Hotel Segamat, Johor
Holiday Villa Service Apartment, Kuala Lumpur
Hyatt Regency Club Subang, Selangor
Kota Bharu City Centre Service Apartment, Kelantan
Kuala Lumpur International Hotel, Kuala Lumpur
Menara Trend Taman Intan Klang, Selangor
Mr J Hotel Wakaf Che Yeh (1) Kota Bharu, Kelantan

Nilai International College Subang, Selangor
Renaissance Hotel, Johor Bharu
Suasana All Suites Hotel, Johor Bharu
Summit Hotel Subang, Selangor
Sunway College Johor Bharu
Sunway University College Subang, Selangor
Sutera Mall, Johor Bharu
The Saujana Hotel Shah Alam, Selangor
W Hotel, Kuala Lumpur (MCC)
Wisma Tong Ah, Kuala Lumpur
Holiday Villa Kota Bharu, Kelantan



THE BRANDLAUREATE
BESTBRANDS
AWARDS 2017-2018
For Water Treatment Solutions



Purity in every drops

**TAKING CARE OF YOUR WATER
SINCE 1981...**



CONTACT WATERCO

Waterco's head office is situated in Sydney, Australia with international offices, manufacturing plants and warehouses located in Australia, New Zealand, Malaysia, Indonesia, Singapore, China, the US, Canada, and the UK.

OFFICES - AUSTRALIA

NSW - Sydney (Head Office)
Tel: +61 2 9898 8600

QLD - Brisbane
Tel: +61 7 3299 9900

VIC/TAS - Melbourne
Tel: +61 3 9764 1211

WA - Perth
Tel: +61 8 9273 1900

SA/NT - Adelaide
Tel: +61 8 8244 6000

ACT Distribution
Tel: +61 2 6280 6476

OFFICES - OVERSEAS

Waterco (Europe) Limited
Sittingbourne, Kent, UK
Tel: +44 (0) 1795 521 733

Waterco (USA) Inc
Augusta, Georgia, USA
Tel: +1 706 793 7291

Waterco Canada
Boucherville, Quebec, Canada
Tel: +1 450 748 1421

Waterco (NZ) Limited
Auckland, New Zealand
Tel: +64 9 525 7570

Waterco (C) Limited
Guangzhou, China
Tel: +86 20 3222 2180

Waterco (Far East) Sdn Bhd
Selangor, Malaysia
Tel: +60 3 6145 6000

PT Waterco Indonesia
Jakarta, Indonesia
Tel: +62 21 4585 1481

Waterco Singapore Intl Pte Ltd
Nehsons Building, Singapore
Tel: +65 6344 2378

DISTRIBUTED BY:

WATERCO
water, the liquid of life



ZZB2015 04/21